



Truss

Ceiling Baffles

Premier Collection

Truss is an acoustic ceiling baffle designed to mimic the natural aesthetic of a real wood beam, without the associated weight and sound reverberation of natural wood. The variety of sizes allows Truss Ceiling Baffles to be used as a singular beam, in various configurations, or together in multiple sizes to create an interesting architectural design.

Specifications

Surface	Ceiling
Material	FilaSorb™ polyester felt
Weight	0.50 lbs to 2.12 lbs per linear ft depending on size
Standard Sizes	Height: 3" up to 20" H (1" increments) Width: 2" up to 12" W (1" increments) Length: 12" up to 108" L (6" increments), 110" L <i>See page 4 for more details. Custom sizes available</i>



Truss Ceiling Baffles in Oregon

Technical

NRC Rating	1.65*
Fire Test	ASTM E84, Class A CAN/ULC-S102 Flame spread index: 15 Smoke developed index: 200
Water Sorption	ASTM C1104-2019 (A Modified) Water sorbed by weight: 0.20% (based on a 12mm thick panel)
Colorfastness	ISO 105-B02, 6-7

* Test results available upon request

Details

Lead Time	3 - 6 weeks
Origin	Manufactured and assembled in the US
Warranty	Product: 20 years* Colorfastness: 20 years*

* Conditions apply

Environmental

Recycled Content	Minimum 60%
Energy	Generated using 40% solar energy
Indoor Air Quality	VOC less than/equal to 0.5mg/m3
Recyclable	100%*
Certifications	Environmental Product Declaration Declare Certification - LBC Red List Free (third-party verified) SCS Global Indoor Advantage Gold

* PET is recyclable through participating partners



For questions or additional product information,
visit acoufelt.com or call **800.966.8557**.

Truss Ceiling Baffles | March 2026

Colorways

PREMIER

							
White WH12	Milkyway MI74	Ivory IV11	Pearl PE21	Valentine VA70	Quartz QU67	Stonewash ST72	Sea Salt SE57
							
Platinum PL04	Almond AL55	Pistachio PI25	Turmeric TU60	Flamingo FL61	Amethyst AM69	Periwinkle PE23	Peacock PE20
							
Metal ME03	Mushroom MU75	Celery CE65	Wheat WH68	Peach PE19	Lilac LI13	Marine MA15	Sencha SE58
							
Grey GR02	Umber UM54	Wasabi WA29	Popcorn PO26	Currant CU59	Berry BE06	Azure AZ05	Oregano OR18
							
Charcoal CH01	Walnut WA56	Eucalyptus EU71	Carrot CA08	Loganberry LO77	Granite GR62	Denim DE09	Kale KA12
							
Piano Black PI24	Slate SL27	Nori NO76	Peppercorn PE22	Shiraz SH63	Flint FL64	Midnight MI16	

Order samples at acoufelt.com/colorways

 For questions or additional product information, visit acoufelt.com or call 800.966.8557.

Truss Ceiling Baffles | March 2026

Sizes

Standard Sizes Height: 3" up to 20" H (1" increments)
 Width: 2" up to 12" W (1" increments)
 Length: 12" up to 108" L (6" increments), 110" L
Custom sizes available

	3"H	4"H	5"H	6"H	7"H	8"H	9"H	10"H	11"H	12"H	13"H	14"H	15"H	16"H	17"H	18"H	19"H	20"H
2"W	■	■	■	■	■	■	■	■	■	■	■	■	■	■	■	■	■	■
3"W	■	■	■	■	■	■	■	■	■	■	■	■	■	■	■	■	■	■
4"W	■	■	■	■	■	■	■	■	■	■	■	■	■	■	■	■	■	■
5"W	■	■	■	■	■	■	■	■	■	■	■	■	■	■	■	■	■	■
6"W	■	■	■	■	■	■	■	■	■	■	■	■	■	■	■	■	■	■
7"W	■	■	■	■	■	■	■	■	■	■	■	■	■	■	■	■	■	■
8"W	■	■	■	■	■	■	■	■	■	■	■	■	■	■	■	■	■	■
9"W	■	■	■	■	■	■	■	■	■	■	■	■	■	■	■	■	■	■
10"W	■	■	■	■	■	■	■	■	■	■	■	■	■	■	■	■	■	■
11"W	■	■	■	■	■	■	■	■	■	■	■	■	■	■	■	■	■	■
12"W	■	■	■	■	■	■	■	■	■	■	■	■	■	■	■	■	■	■

■ Standard sizes

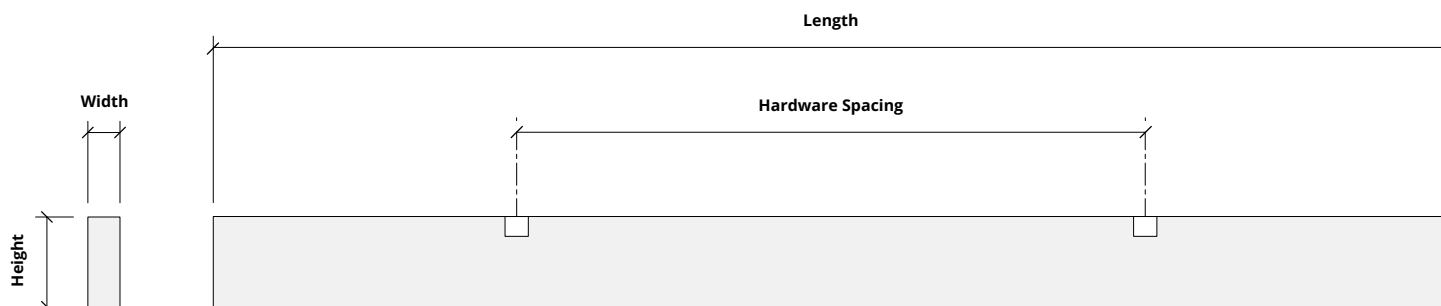

For questions or additional product information, visit acoufelt.com or call 800.966.8557.

Truss Ceiling Baffles | March 2026

Hardware Spacing

12, 18" L	6" on center spacing
24, 30" L	12" on center spacing
36, 42, 48, 54" L	24" on center spacing
60, 66, 72, 78, 84, 90" L	48" on center spacing
96, 102, 108, 110" L	60" on center spacing

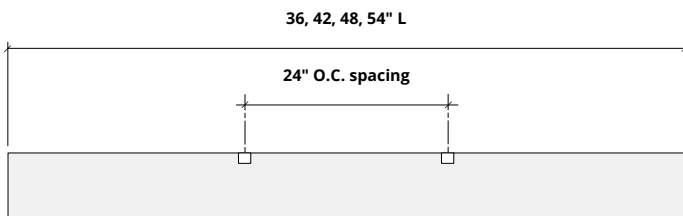
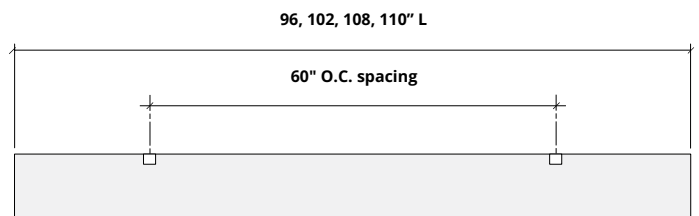
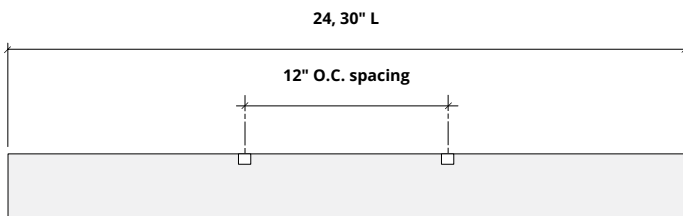
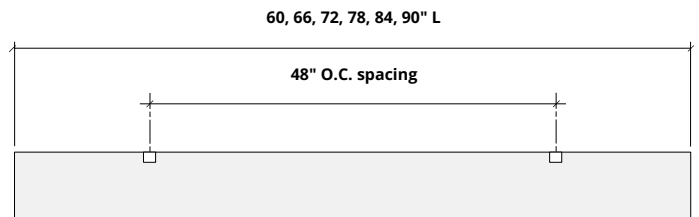
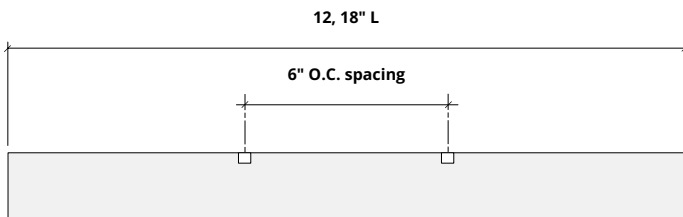

How to Specify

1. Choose Height

2. Choose Width

3. Choose Length

4. Choose Colorways

Select height based on desired design: 3" up to 20" H (1" increments)

1. Choose Height

2. Choose Width

3. Choose Length

4. Choose Colorways

Select width: 2" 4", 6", 8", 10" or 12" W.

1. Choose Height

2. Choose Width

3. Choose Length

4. Choose Colorways

Truss baffles come in the standard lengths of: 12", 18", 24", 30", 36", 42", 48", 54", 60", 66", 72", 78", 84", 90", 96", 102", 108, 110" L.

1. Choose Height

2. Choose Width

3. Choose Length

4. Choose Colorways

See colorway choices on page 3.



For questions or additional product information,
visit [acoufelt.com](https://www.acoufelt.com) or call **800.966.8557**.

Truss Ceiling Baffles | March 2026

Mounting Methods

Cable to deck

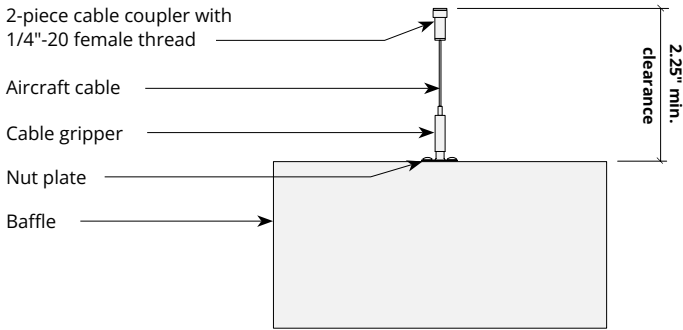

Hardware Kits:
 HK1006 - 48" Cable
 HK1010 - 120" Cable

Cable to T-grid

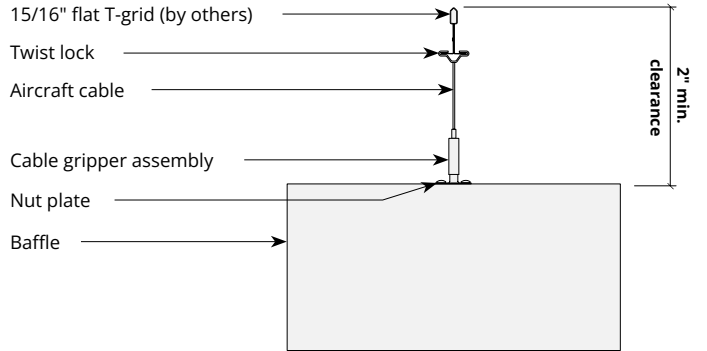

Hardware Kits:
 HK1008 - 48" Cable
 HK1012 - 120" Cable

Cable to strut channel

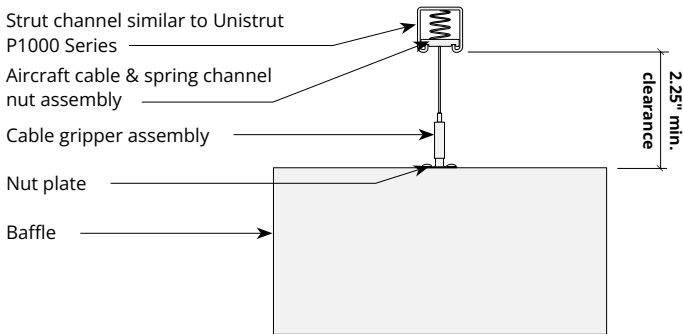

Hardware Kits:
 HK1009 - 48" Cable
 HK1013 - 120" Cable

Swivel cable to deck

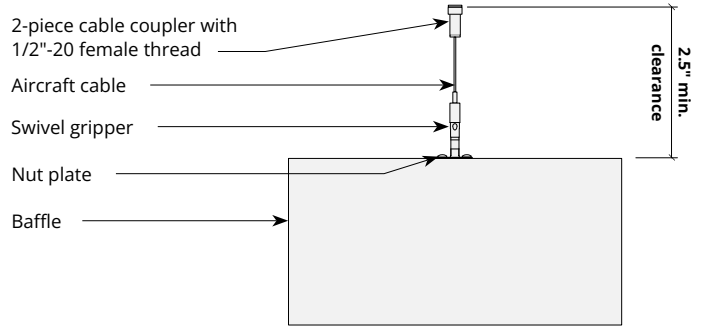

Hardware Kits:
 HK1007 - 48" Cable
 HK1011 - 120" Cable

Threaded rod

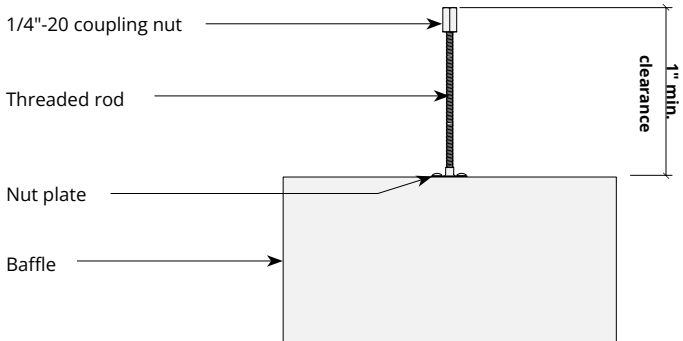

Hardware Kits:
 HK1014 - 24" Cable
 HK1015 - 48" Cable

Threaded rod to strut channel

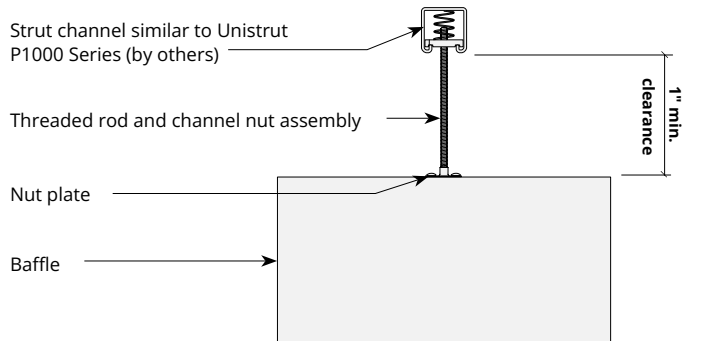

Hardware Kits:
 HK1277 - 24" Cable
 HK1278 - 48" Cable

Mounting Methods cont'd.

Twist lock to T-grid

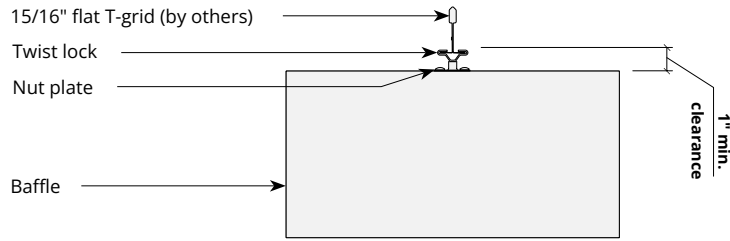

Hardware Kits:
HK1017

Acoustic Performance

Test Method	ASTM E795-16
Install Method	J-600
Rating Method	ASTM C423-17
Mounting Method	Sample tested 5 baffles 110" L x 12" D x 3" thickness, hanging 600mm from floor and 152mm from each other
Test Results	NRC 1.65 SAA 1.68



Frequency f (Hz)	125	250	500	1000	2000	4000	NRC
3" Truss Baffle	0.26	0.86	1.25	2.02	2.49	2.49	1.65

What is a Noise Reduction Coefficient (NRC)?

You'll find the NRC rating in the specifications of all of our products. This acronym stands for Noise Reduction Coefficient, and is expressed as a single number, a rating that describes the degree to which acoustic products can absorb sound.

You can use NRC values to understand the overall performance of our acoustic wall and ceiling products. The higher the NRC, the better the product is at soaking up the sound.

Performance Indices: Noise Reduction Coefficient (NRC) results represent the absorption coefficients measured at the one third octave bands at 125, 250, 500, 1000, 2000 and 4000 Hz rounded to the nearest 0.05. Acoustic testing has been performed according to the methods mentioned above. Customization of installation of the product could alter the results. Sound Absorption Average (SAA) indicates the absorption coefficient average for the twelve one-third octave bands ranging between 200 and 2500 Hz.

 For questions or additional product information, visit [acoufelt.com](https://www.acoufelt.com) or call **800.966.8557**.

Truss Ceiling Baffles | March 2026