

Skipping Stones Ceiling Clouds

Premier Collection

Skipping Stones is a collection of sculptural clouds that captivate the eye and transform its surroundings. Ideal for expansive, open areas, these clouds command attention while maintaining a sense of lightness. Gently rounded edges soften their grand presence, creating an inviting, almost floating effect that adds depth and dimension to any space. The interior is softly detailed, offering a refined look that can be enhanced with optional integrated lighting. Available in five distinct models, each design can stand alone or be hung in multiples to form a luminous, floating centerpiece that elevates any environment.

Specifications

Surface	Ceiling
Material	FilaSorb™ polyester felt
Weight	0.49 lb./ft ² (±10%)
Standard Sizes	Heights: 10, 20" H Widths: 27, 39, 40, 48" W Lengths: 38, 48, 62, 63, 96" L



Skipping Stones Ceiling Clouds in Perwinkle, Marine, and Granite

* Any lighting depicted in renderings is for illustrative purposes only and is not included with the product. All lighting must be specified and coordinated by the project lighting designer or electrical engineer.

Technical

NRC Rating	1.90*
Fire Test	ASTM E84, Class A CAN/ULC-S102 Flame spread index: 15 Smoke developed index: 200
Water Sorption	ASTM C1104-2019 (A Modified) Water sorbed by weight: 0.20% (based on a 12mm thick panel)
Colorfastness	ISO 105-B02, 6-7

* Rating is estimated based on similar product designs. Comparison NRC results available upon request

Details

Lead Time	3 – 6 weeks
Origin	Manufactured and assembled in the US
Warranty	Product: 20 years* Colorfastness: 20 years*

* Conditions apply

Environmental

Recycled Content	Minimum 60%
Energy	Generated using 40% solar energy
Indoor Air Quality	VOC less than/equal to 0.5mg/m3
Recyclable	100%*
Certifications	Declare Certification - LBC Red List Free (third-party verified) SCS Global Indoor Advantage Gold

* PET is recyclable through participating partners



For questions or additional product information, visit [acoufelt.com](https://www.acoufelt.com) or call 800.966.8557.

Skipping Stones Ceiling Clouds | January 2026

Colorways

PREMIER



White
WH12



Milkyway
MI74



Ivory
IV11



Pearl
PE21



Valentine
VA70



Quartz
QU67



Stonewash
ST72



Sea Salt
SE57

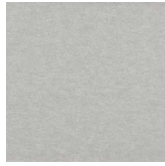

Platinum
PL04



Almond
AL55



Pistachio
PI25



Turmeric
TU60

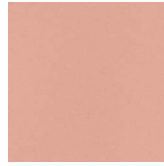

Flamingo
FL61



Amethyst
AM69



Periwinkle
PE23



Peacock
PE20

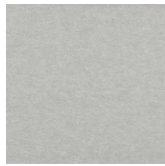

Metal
ME03



Mushroom
MU75



Celery
CE65



Wheat
WH68



Peach
PE19



Lilac
LI13



Marine
MA15



Sencha
SE58



Grey
GR02



Umber
UM54

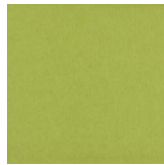

Wasabi
WA29



Popcorn
PO26



Currant
CU59



Berry
BE06



Azure
AZ05



Oregano
OR18



Charcoal
CH01



Walnut
WA56



Eucalyptus
EU71

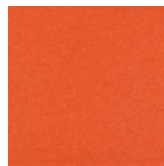

Carrot
CA08

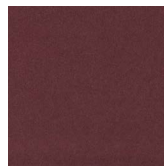

Loganberry
LO77



Granite
GR62

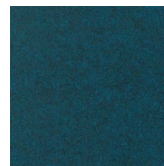

Denim
DE09



Kale
KA12

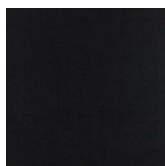

Piano Black
PI24



Slate
SL27

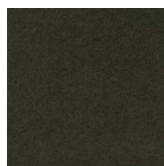

Nori
NO76

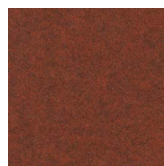

Peppercorn
PE22

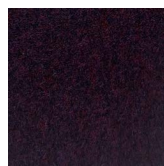

Shiraz
SH63

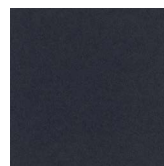

Flint
FL64

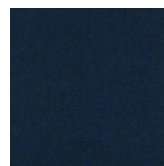

Midnight
MI16

Order samples at acoufelt.com/colorways

 For questions or additional product information, visit acoufelt.com or call 800.966.8557.

Skipping Stones Ceiling Clouds | January 2026

Sizes

Standard Sizes Height: 10, 20" H
 Widths: 27, 39, 40, 48" W
 Lengths: 38, 48, 62, 63, 96" L

Plans

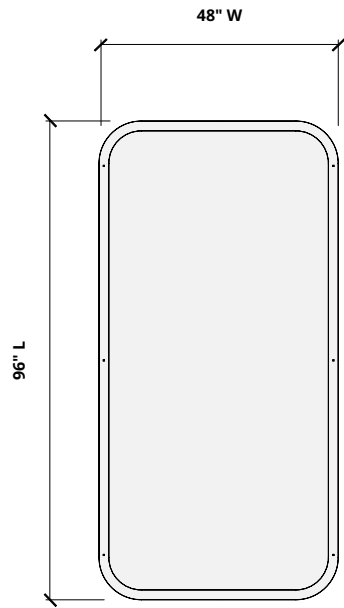

SKIPPING STONE A

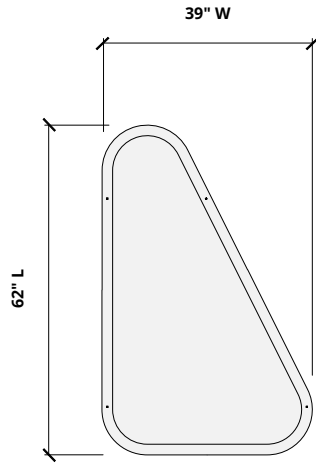

SKIPPING STONE B

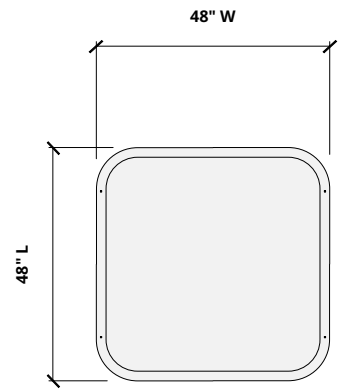

SKIPPING STONE C

Elevations

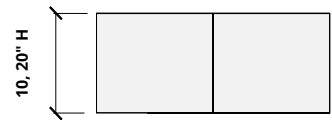
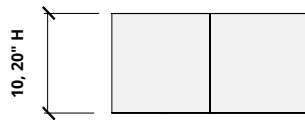
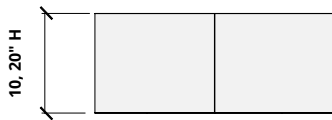

Perspectives

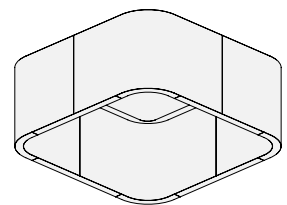
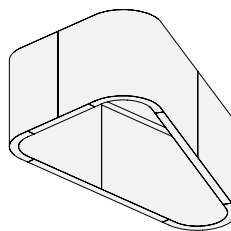
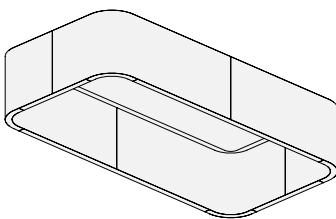

Models can be mixed and matched to create a desired pattern.

 For questions or additional product information, visit [acoufelt.com](https://www.acoufelt.com) or call 800.966.8557.

Skipping Stones Ceiling Clouds | January 2026

Sizes (cont.)

Plans

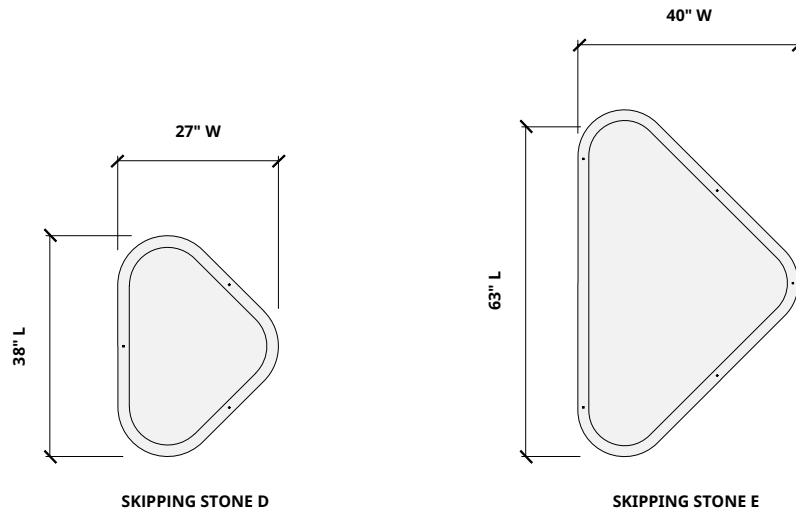

Elevations



Perspectives

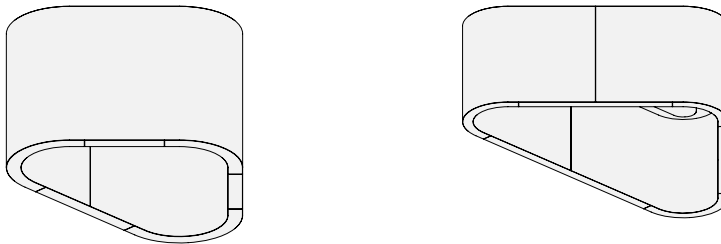

Models can be mixed and matched to create a desired pattern.

How to Specify

1. Choose Model

2. Choose Height

3. Choose Colorways

Skipping Stones Clouds are available in 5 models. You can mix and match the models to create your overall design.

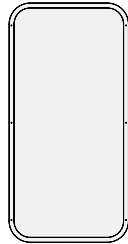

Skipping Stone A

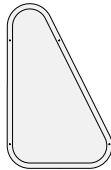

Skipping Stone B

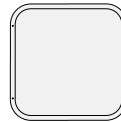

Skipping Stone C

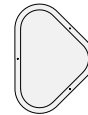

Skipping Stone D

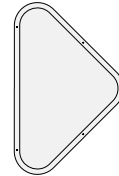

Skipping Stone E

1. Choose Model

2. Choose Height

3. Choose Colorways

Clouds are available in two heights: 10" and 20". Multiple heights can be selected based on the overall desired design.

1. Choose Model

2. Choose Height

3. Choose Colorways

Select one or multiple colorways to achieve the overall desired design. See colorway choices on page 3.

Mounting Methods

Cable to deck

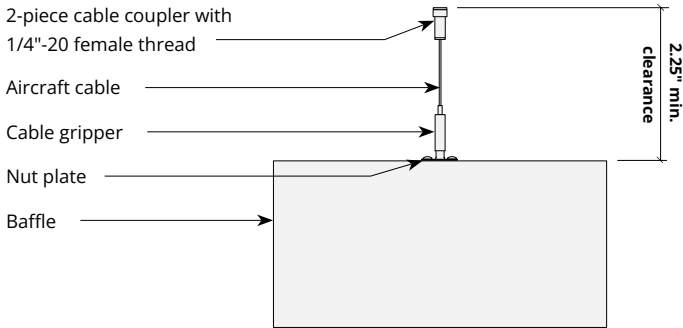

Hardware Kits:
 HK1006 - 48" Cable
 HK1010 - 120" Cable

Swivel cable to deck

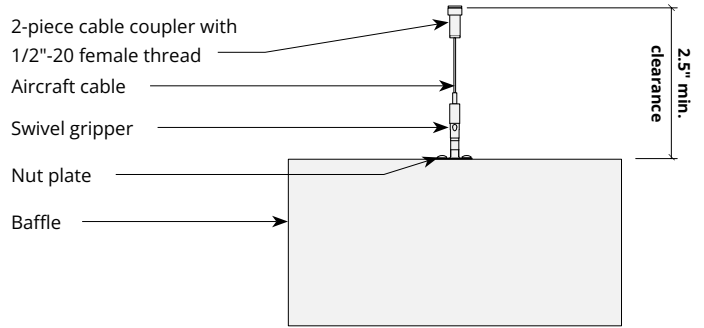

Hardware Kits:
 HK1007 - 48" Cable
 HK1011 - 120" Cable

Cable to strut channel

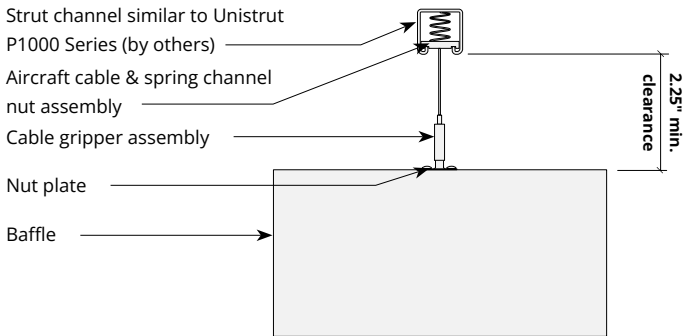

Hardware Kits:
 HK1009 - 48" Cable
 HK1013 - 120" Cable

Threaded rod

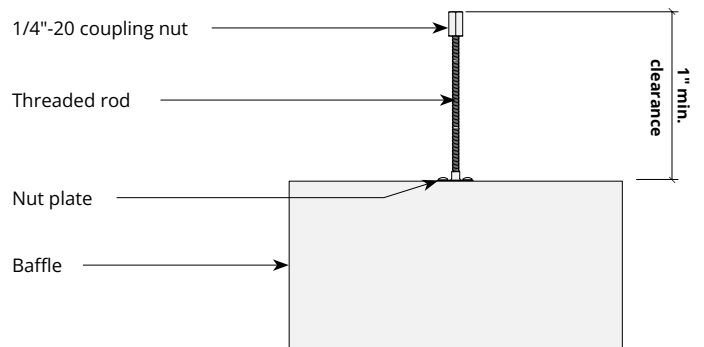

Hardware Kits:
 HK1014 - 24" Cable
 HK1015 - 48" Cable

Threaded rod to strut channel

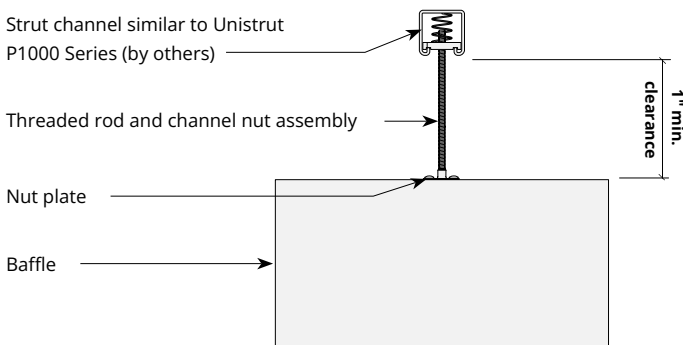

Hardware Kits:
 HK1277 - 24" Cable
 HK1278 - 48" Cable

Direct to strut channel

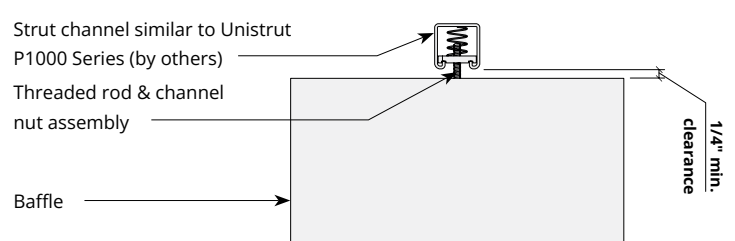

Hardware Kits:
 HK1016

Acoustic Performance

Test Method	ASTM C423-17
Install Method	Type A
Rating Method	ISO 11654-2007
Test Results	NRC 1.90

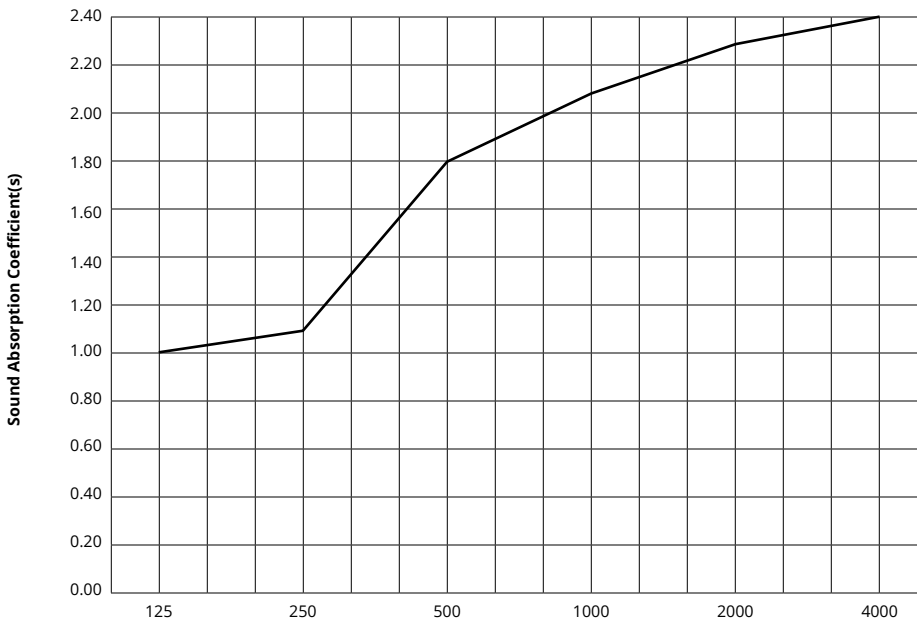

Frequency f (Hz)	125	250	500	1000	2000	4000	NRC
12mm	1.00	1.30	1.80	2.10	2.30	2.40	1.90

What is a Noise Reduction Coefficient (NRC)?

You'll find the NRC rating in the specifications of all of our products. This acronym stands for Noise Reduction Coefficient, and is expressed as a single number, a rating that describes the degree to which acoustic products can absorb sound.

You can use NRC values to understand the overall performance of our acoustic wall and ceiling products. The higher the NRC, the better the product is at soaking up the sound.

Performance Indices: Noise Reduction Coefficient (NRC) results represent the absorption coefficients measured at the one third octave bands at 125, 250, 500, 1000, 2000 and 4000 Hz rounded to the nearest 0.05. Acoustic testing has been performed according to the methods mentioned above. Customization of installation of the product could alter the results. Sound Absorption Average (SAA) indicates the absorption coefficient average for the twelve one-third octave bands ranging between 200 and 2500 Hz.

 For questions or additional product information, visit [acoufelt.com](https://www.acoufelt.com) or call **800.966.8557**.

Skipping Stones Ceiling Clouds | January 2026