



Truss LED Ceiling Baffles

WoodGrain Collection

Popular Truss ceiling baffles with integrated LED lighting produce a lean, aerodynamic look. Diffused LED lighting channels embedded in sound absorbing baffles reduce noise while efficiently illuminating the space. Acoufelt's advanced manufacturing technology gives you the latitude to specify a standard lighting option or embed your own lighting components.

Specifications

Surface	Ceiling
Material	FilaSorb™ polyester felt
Thickness	1/2", 12mm (±10%)
Weight	0.49 lb./ft ² (±10%)
Standard Sizes	Height: 3" up to 20" H (1" increments) Depth: 3" up to 12" D (1" increments) Length: 12" up to 108" L (6" increments), 110" L <i>See page 4 for more details. Custom sizes available</i>

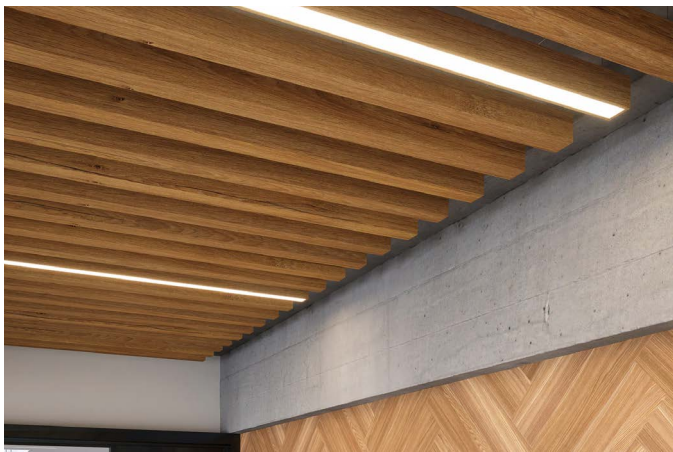

Truss LED Ceiling Baffle in Log Cabin

Technical

NRC Rating	1.65*
Fire Test	ASTM E84, Class A CAN/ULC-S102 Flame spread index: 15 Smoke developed index: 200
Water Sorption	ASTM C1104-2019 (A Modified) Water sorbed by weight: 0.20% (based on a 12mm thick panel)
Colorfastness	ISO 105-B02, 6-7

* Test results available upon request.

Details

Lead Time	3 - 6 weeks
Origin	Manufactured and assembled in the US
Warranty	Product: 20 years* Colorfastness: 20 years*

* Conditions apply

Environmental

Recycled Content	Minimum 60%
Energy	Generated using 40% solar energy
Indoor Air Quality	VOC less than/equal to 0.5mg/m ³
Recyclable	100%*
Certifications	Environmental Product Declaration Declare Certification - LBC Red List Free (third-party verified) SCS Global Indoor Advantage Gold

* PET is recyclable through participating partners.



For questions or additional product information, visit [acoufelt.com](https://www.acoufelt.com) or call **800.966.8557**.

Truss LED Ceiling Baffles | January 2026

Colorways

WOODGRAIN



Picket Fence
WQ01



Loft
WQ06



White Elm
WQ07



Lyed Larch
WQ30



White Oak
WQ13



Baltic Birch
WQ12



Knotty Spruce
WQ29



French Bobbin
WQ08



Boat Shed
WQ02



Nordic Plank
WQ15



Boardwalk
WQ10



Mocha Legno
WQ25



Mountain Lodge
WQ24

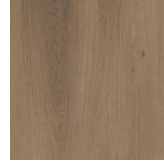

Wine Barrel
WQ03



Log Cabin
WQ04



Natural Oak
WQ16



Woodland Fog
WQ22



Driftwood
WQ21



Weathered Slate
WQ14



Petrified Ash
WQ23

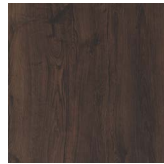

Antique Chest
WQ11

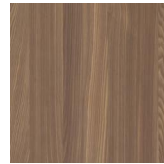

European Larch
WQ17

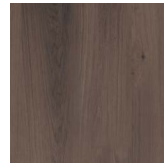

Fumed Oak
WQ19



Teak
WQ18



Charred Larch
WQ09



Shadow Oak
WQ28



Barn Door
WQ05



Black Walnut
WQ20



Scorched Timber
WQ26



Espresso Oak
WQ27

Order samples at acoufelt.com/colorways

Sizes

Standard Sizes Height: 3" up to 20" H (1" increments)
 Depth: 3" up to 12" D (1" increments)
 Length: 12" up to 108" L (6" increments), 110" L
Custom sizes available

Thickness 1/2", 12mm (±10%)

	3"H	4"H	5"H	6"H	7"H	8"H	9"H	10"H	11"H	12"H	13"H	14"H	15"H	16"H	17"H	18"H	19"H	20"H
3"D	Standard	Standard	Standard	Standard	Standard	Standard	Standard	Standard	Standard	Standard	Standard	Standard	Standard	Standard	Standard	Standard	Standard	Standard
4"D	Standard	Standard	Standard	Standard	Standard	Standard	Standard	Standard	Standard	Standard	Standard	Standard	Standard	Standard	Standard	Standard	Standard	Standard
5"D	Standard	Standard	Standard	Standard	Standard	Standard	Standard	Standard	Standard	Standard	Standard	Standard	Standard	Standard	Standard	Standard	Standard	Standard
6"D	Standard	Standard	Standard	Standard	Standard	Standard	Standard	Standard	Standard	Standard	Standard	Standard	Standard	Standard	Standard	Standard	Standard	Standard
7"D	Standard	Standard	Standard	Standard	Standard	Standard	Standard	Standard	Standard	Standard	Standard	Standard	Standard	Standard	Standard	Standard	Standard	Standard
8"D	Standard	Standard	Standard	Standard	Standard	Standard	Standard	Standard	Standard	Standard	Standard	Standard	Standard	Standard	Standard	Standard	Standard	Standard
9"D	Standard	Standard	Standard	Standard	Standard	Standard	Standard	Standard	Standard	Standard	Standard	Standard	Standard	Standard	Standard	Standard	Standard	Standard
10"D	Standard	Standard	Standard	Standard	Standard	Standard	Standard	Standard	Standard	Standard	Standard	Standard	Standard	Standard	Standard	Standard	Standard	Standard
11"D	Standard	Standard	Standard	Standard	Standard	Standard	Standard	Standard	Standard	Standard	Standard	Standard	Standard	Standard	Standard	Standard	Standard	Standard
12"D	Standard	Standard	Standard	Standard	Standard	Standard	Standard	Standard	Standard	Standard	Standard	Standard	Standard	Standard	Standard	Standard	Standard	Standard

 Standard sizes

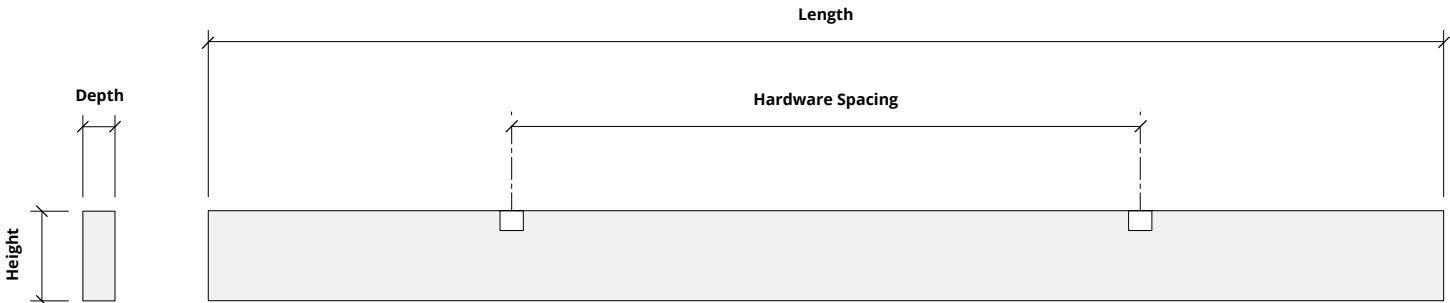

Hardware Spacing

12, 18" L	6" on center spacing
24, 30" L	12" on center spacing
36, 42, 48, 54" L	24" on center spacing
60, 66, 72, 78, 84, 90" L	48" on center spacing
96, 102, 108, 110" L	60" on center spacing

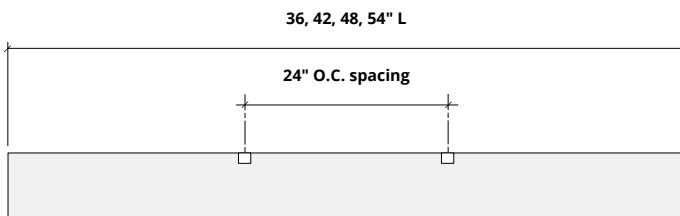
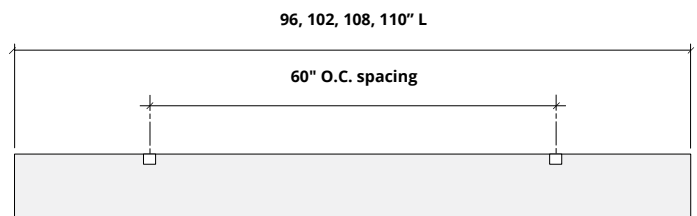
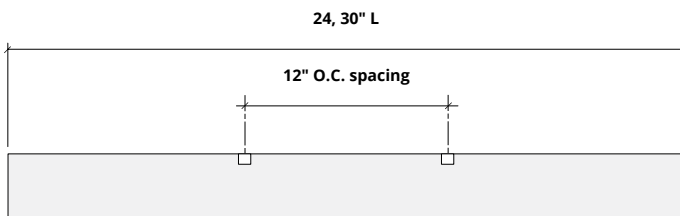
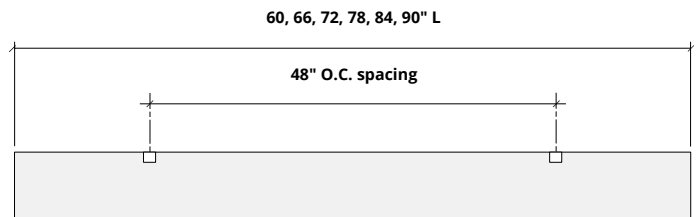
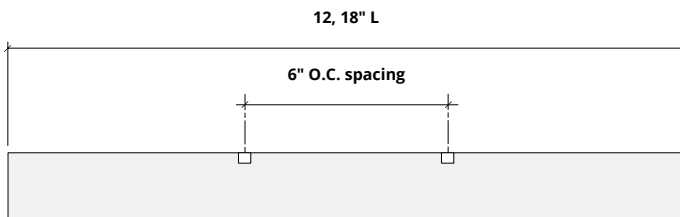

How to Specify

1. Choose Height

2. Choose Width

3. Choose Length

4. Choose Colorways

5. Choose Lighting

Select height based on desired design: 3" up to 20" H (1" increments)

1. Choose Height

2. Choose Width

3. Choose Length

4. Choose Colorways

5. Choose Lighting

Select width: 2" 4", 6", 8", 10" or 12" W.

1. Choose Height

2. Choose Width

3. Choose Length

4. Choose Colorways

5. Choose Lighting

Truss baffles come in the standard lengths of: 12", 18", 24", 30", 36", 42", 48", 54", 60", 66", 72", 78", 84", 90", 96", 102", 108, 110" L.

1. Choose Height

2. Choose Width

3. Choose Length

4. Choose Colorways

5. Choose Lighting

See colorway choices on page 3.

1. Choose Height

2. Choose Width

3. Choose Length

4. Choose Colorways

5. Choose Lighting

Select lumen output and color temperature:

- LED output: 600 lm/ft or 1000 lm/ft
- CCT: 3000K, 3500K or 4000K
- CRI: 90+

Mounting Methods

Cable

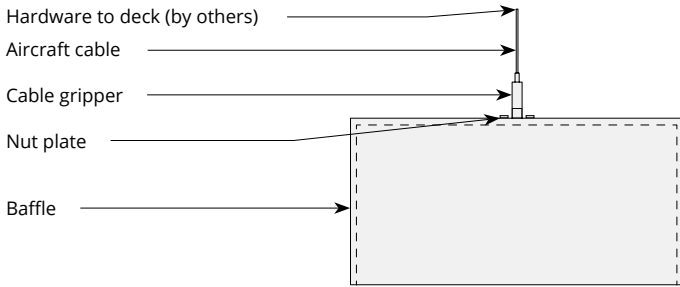

Cable to deck

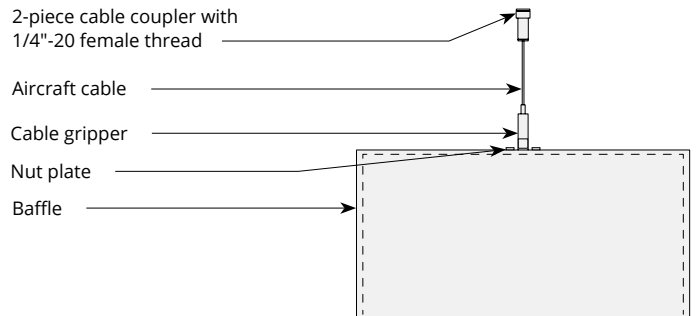

Cable to T-grid

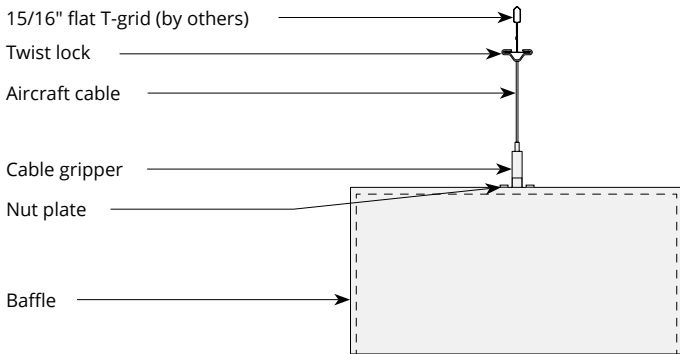

Cable to Unistrut

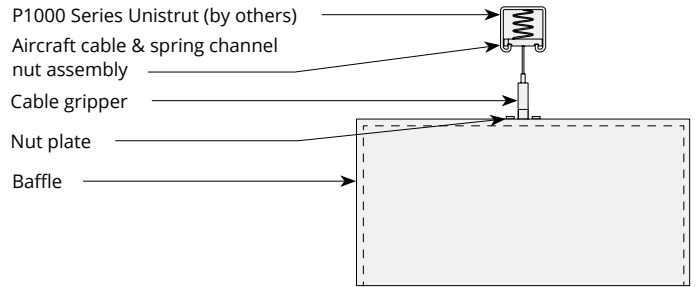

Swivel cable to deck

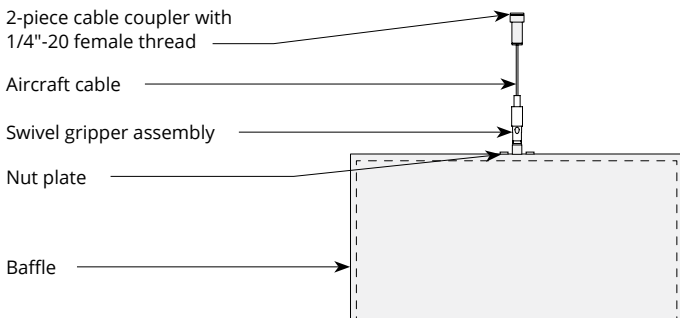

Threaded rod

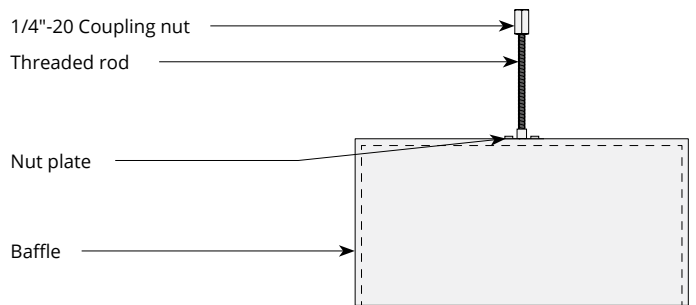

Mounting Methods cont'd.

Threaded rod to Unistrut

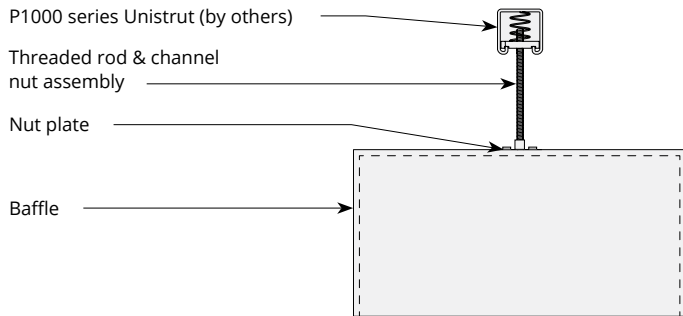

Direct to Unistrut

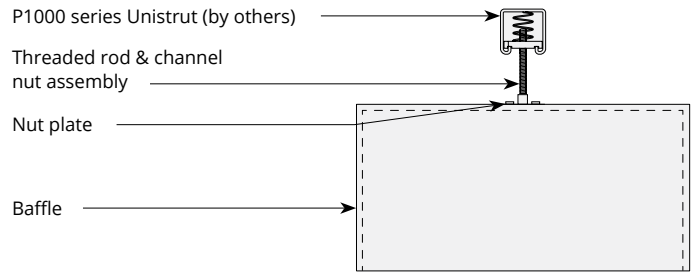

Twist lock to T-grid

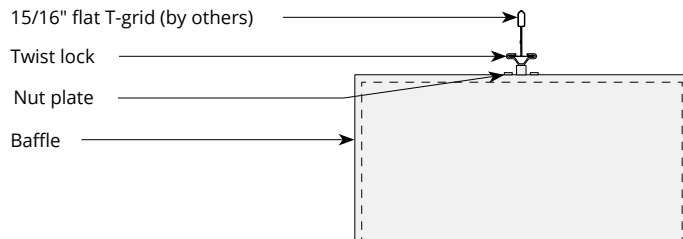

Acoustic Performance

Test Method	ASTM E795-16
Install Method	J-600
Rating Method	ASTM C423-17
Mounting Method	Sample tested 5 baffles 110" L x 12" D x 3" thickness, hanging 600mm from floor and 152mm from each other
Test Results	NRC 1.65 SAA 1.68



Frequency f (Hz)	125	250	500	1000	2000	4000	NRC
3" Truss Baffle	0.26	0.86	1.25	2.02	2.49	2.49	1.65

What is a Noise Reduction Coefficient (NRC)?

You'll find the NRC rating in the specifications of all of our products. This acronym stands for Noise Reduction Coefficient, and is expressed as a single number, a rating that describes the degree to which acoustic products can absorb sound.

You can use NRC values to understand the overall performance of our acoustic wall and ceiling products. The higher the NRC, the better the product is at soaking up the sound.

Performance Indices: Noise Reduction Coefficient (NRC) results represent the absorption coefficients measured at the one third octave bands at 125, 250, 500, 1000, 2000 and 4000 Hz rounded to the nearest 0.05. Acoustic testing has been performed according to the methods mentioned above. Customization of installation of the product could alter the results. Sound Absorption Average (SAA) indicates the absorption coefficient average for the twelve one-third octave bands ranging between 200 and 2500 Hz.

For questions or additional product information, visit acoufelt.com or call **800.966.8557**.

Truss LED Ceiling Baffles | January 2026